

ZEN-PL6060B 40W 4000K

LED Panel Light Specification List

FEATURES:

- Super slim design, save 70% energy, High efficiency 88LM/W with uniformed luminance.
- Life span: 50,000 hours
- Wide range of input voltage: AC100-270V
- Instant start, no noise, no flickering
- New high efficiency constant current driver.
- Professional circuit design, each group of LEDs work separately to avoid any problem of lighting output caused by single faulty LED.
- No electrical wave interference, conforms to the standard of CE.
- Environmentally friendly, conforms to the standard of ROHS.
- No RF interference.
- Available in 'Standard' and 'Emergency' version.
- No Ultra Violet Light.
- Three Year Guarantee
- Low maintenance
- Epistar LED Chips.
- No disposal issues.
- No WEE Charge.
- UK Supplier

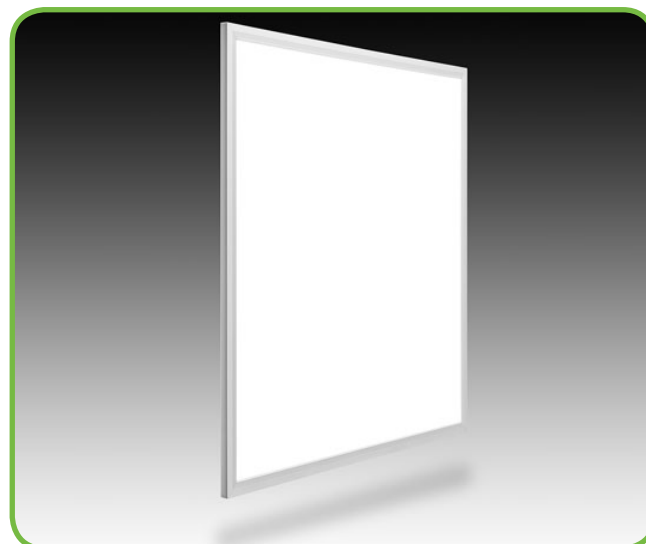

APPLICATIONS:

- Hotel
- Meeting Room
- Factory & Office
- Commercial Purpose
- Residential & Institution
- School
- Hospital
- Retail Outlets
- Museum / Gallery

| Technical Parameters | |
|----------------------|--------------------------------|
| Input Voltage | AC 110-277V(UL) AC100-240V(CE) |
| Working Voltage | 40V |
| Input Power | 40W |
| Luminous | 3400 lm |
| Power Efficiency | 85 lm/w |
| Color | Natural White 4500K |
| Color Temp | NW / Natural White 4000-4500K |
| CRI | 3014 >82 |
| LED Qty | 36W - 352 PCS |
| LED Type | Epistar LED Chips |
| Life Span | 50,000 Hours |
| Operating Temp | -20°C — 50°C |
| Storage Temp | -20°C — 60°C |
| Net Weight | 4.0 Kg |
| Gross Weight | 4.5 Kg |
| IP | IP 40 |

PRODUCT DIMENSIONS

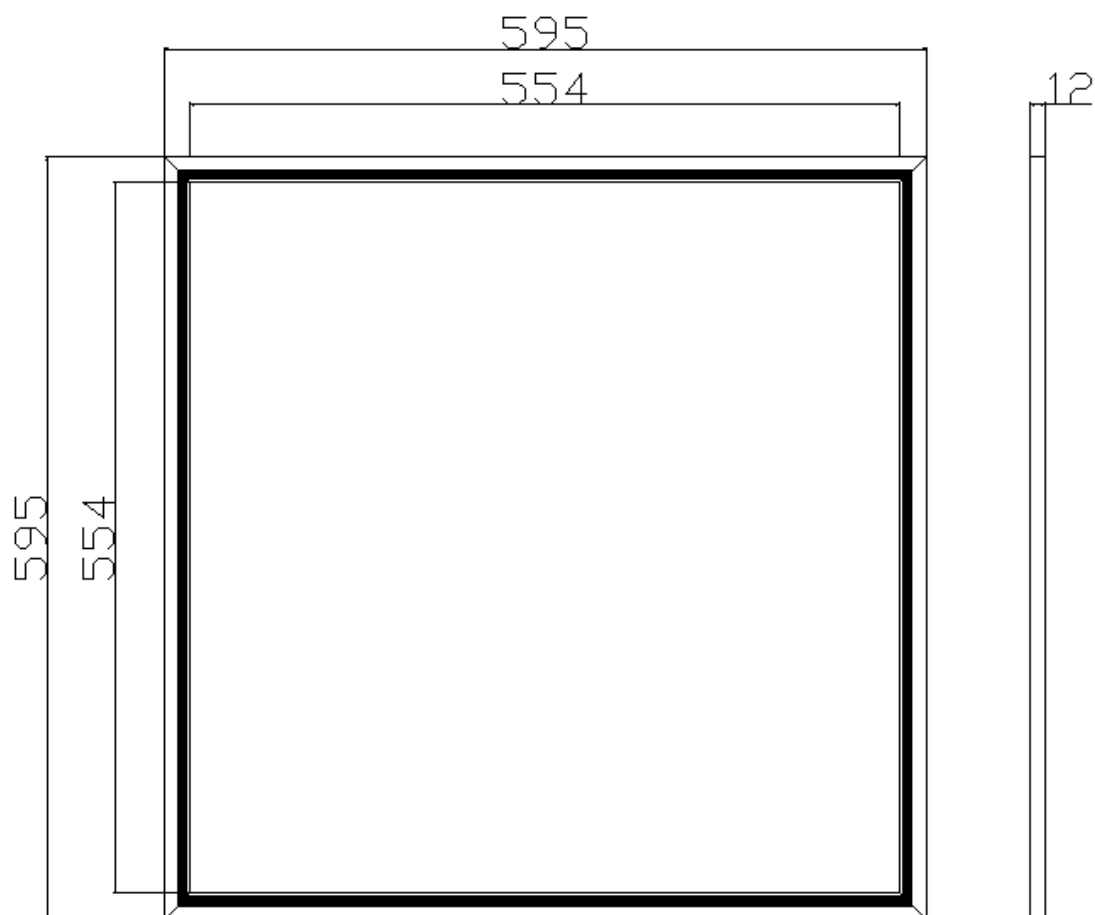

1. The above dimension are based on “mm”
2. There is a tolerance about $\pm 0.5\text{mm}$

LUMINOUS DISTRIBUTION

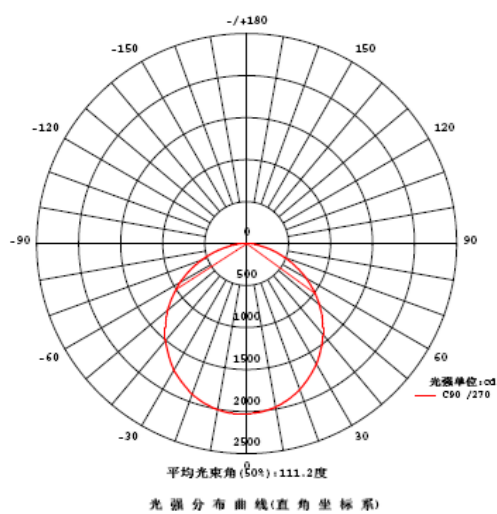
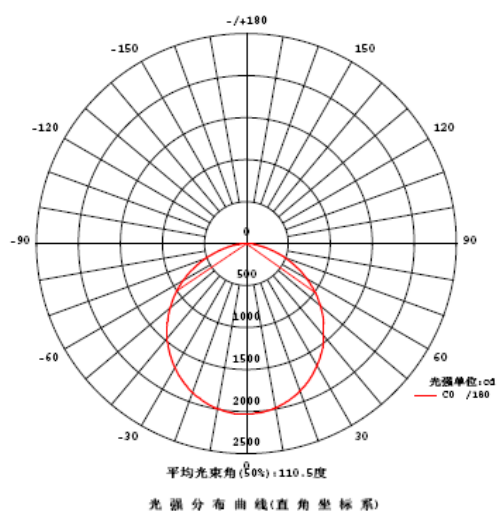

LUMINANCE

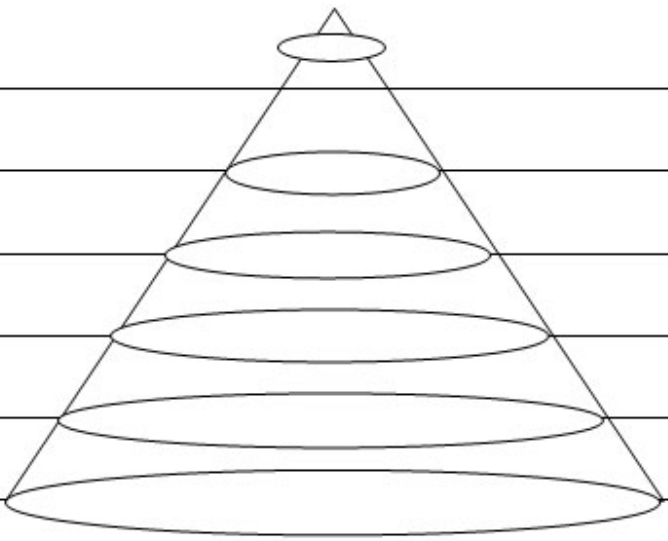
| Distance | | Central Illuminance | | | | | |
|----------|---|---------------------|------|------|------|------|------|
| | | | | | | | |
| |  | | | | | | |
| 1m | | 832 | 1039 | 1199 | 1438 | 1714 | 2028 |
| 1.5m | | 388 | 582 | 621 | 687 | 786 | 1089 |
| 2m | | 208 | 259 | 305 | 357 | 428 | 506 |
| 2.5m | | 133 | 166 | 182 | 227 | 273 | 313 |
| 3m | | 92 | 115 | 132 | 159 | 190 | 225 |
| Power | | 27W | 36W | 42W | 48W | 54W | 72W |

LED LIFE PREDICTION

LUMENMAX

LM-80 report

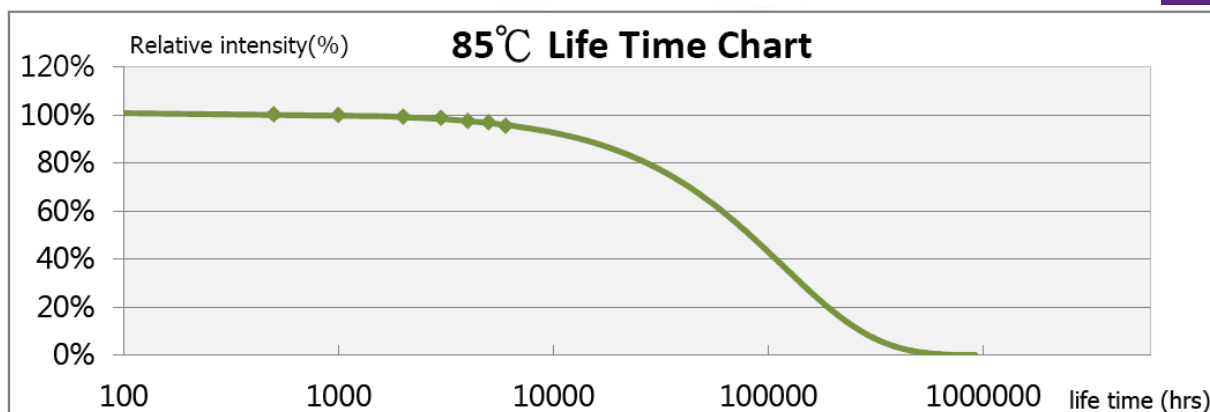

[Condition : 100mA, 85°C]

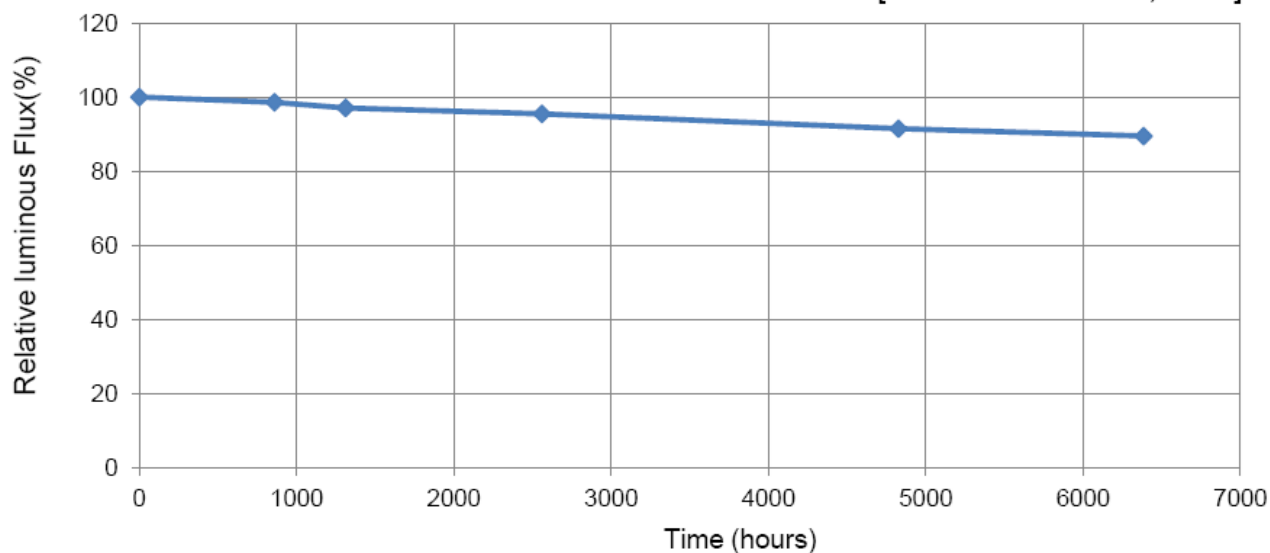

INSTALLATION METHODS

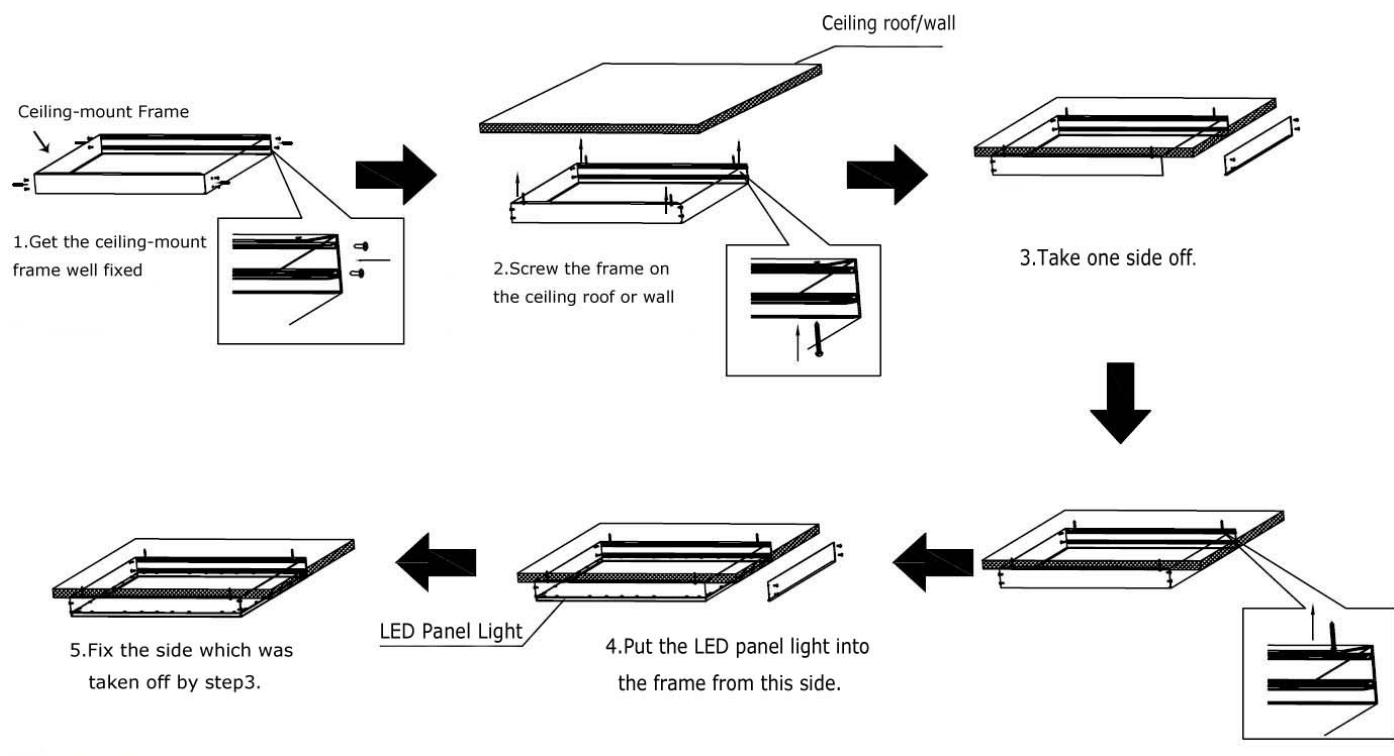

SUSPENDED TYPE

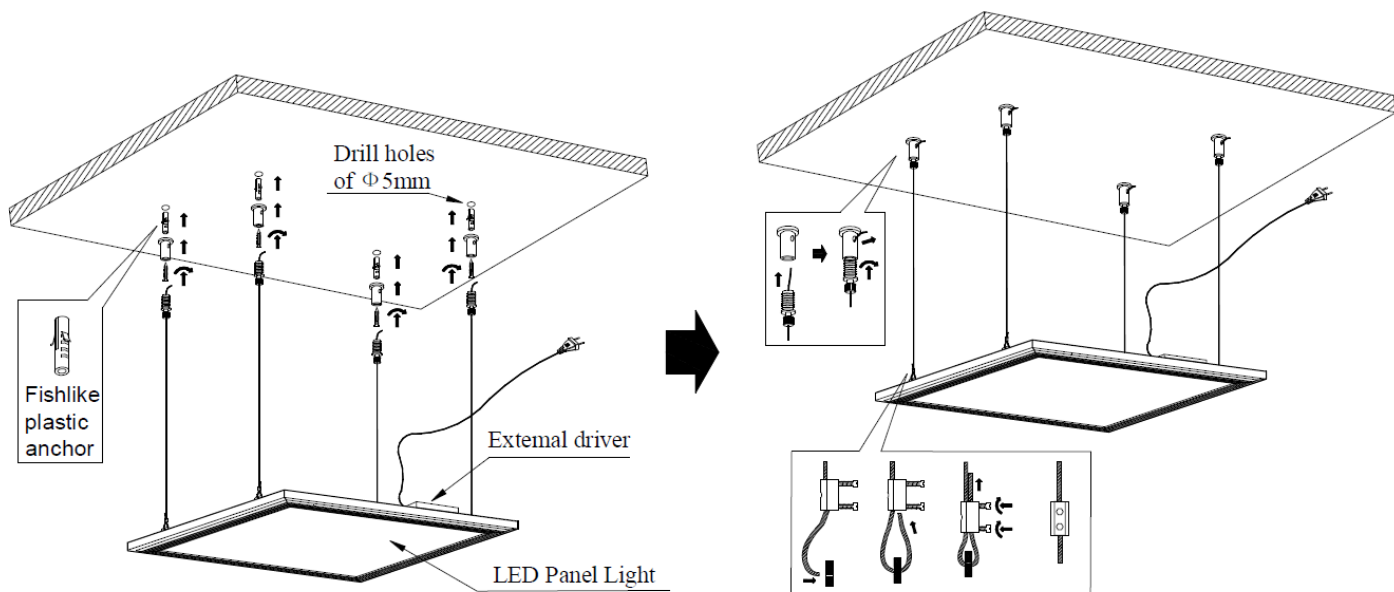

RECESSED

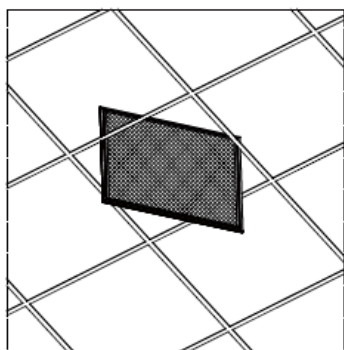

CEILING MOUNTED

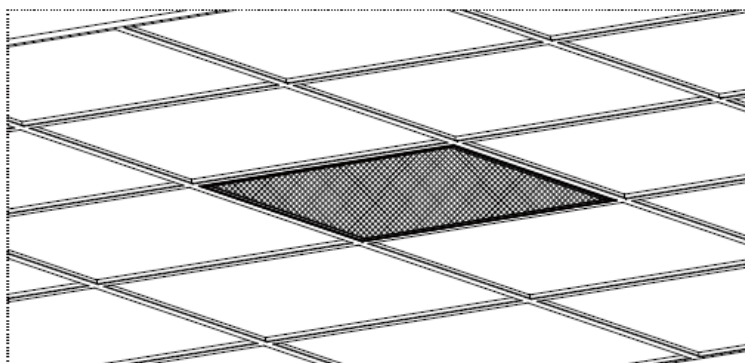

ATTENTION ON INSTALLATION

1. Panel lights should be installed by trained electrician.
2. Please check all the accessories when open the cartons.
3. The distance between the light and any flammable materials must be more than 0.2m. The distance between the upper part of the installed light and the ceiling must not be less than 2 cm. Don not install into ceilings or walls that contain heat source. The main cable must not connect with the low voltage cable or the surface-mounted lights.
4. Guide the lights' connecting cables through the drilled hole, and fix the surface-mounted lights with the pre-fitted clips. Make sure that these are securely connected to the base material.
5. When laying the cables, make sure that the cables and plugs are not subjected to any tensile or twisting forces. Do not kink cables. Output cables should be laid separately and at a distance from other cables.
6. After installation, connect the transformer to the mains supply
7. Proceed by connecting the wiring cables to the lights. Usually, the brown (or black) wire is the Live wire, connect it with the terminal marked "L". The blue wire is Naughty wire; connect it with the terminal marked "N".
8. Use the dedicated LED drivers only, do not connect to other loads
9. Do not remove the label of the lights and drivers.

NOTES ON USING

1. Please always use the light out of its package.
2. Before starting use of the light, please check if the light was damaged during transportation. If any damage shown, please DO not install or use it.
3. Any maintenance should be performed by trained professionals only.
4. Keep packaging material away from the reach of children and pets.
5. Caution: Keep children away from the lights, there are some small components that may be swallowed by children, and never allow them to play with electrical devices.
6. Try to avoid looking directly at lights for a long time. Do not shine the LED light in another person's eyes.
7. Never cover the lights by other objects
8. Keep the panel light away from the flames or heat sources.
9. The lights should be inspected repaired or special treatment if beyond service time.
10. Non-professionals are not allowed to disassemble and maintain the products. We have the right not to provide after-sale service if unauthorized disassembly and maintenance happens to the products.

MAINTENANCE

1. Before to clearing the panel lights, please make sure it have been powered OFF.
2. Use a dry or slightly moistened cloth for cleaning.
3. Never use any chemicals or abrasives for cleaning.